

BSPT TAPER MALE 60° FLARE

MASCHIO BSPT CONICO SVASATURA 60°

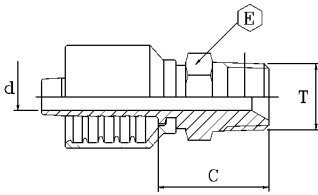

AGR-K

part nr. codice	hose ID			thread T	d		hex E			cut-off C	
	[in]	[mm]	size		[in]	[mm]	[in]	[mm]	key	[in]	[mm]
SP02010410	1/4	6,4	4	1/8-28	0,16	4,0	0,47	12	1/2"	0,91	23
SP02010413	1/4	6,4	4	1/4-19	0,16	4,0	0,59	15	5/8"	1,10	28
SP02010417	1/4	6,4	4	3/8-19	0,16	4,0	0,75	19	3/4"	1,10	28
SP02010513	5/16	8	5	1/4-19	0,22	5,5	0,59	15	5/8"	1,10	28
SP02010517	5/16	8	5	3/8-19	0,22	5,5	0,75	19	3/4"	1,10	28
SP02010613	3/8	9,5	6	1/4-19	0,28	7,0	0,59	15	5/8"	1,10	28
SP02010617	3/8	9,5	6	3/8-19	0,28	7,0	0,75	19	3/4"	1,10	28
SP02010621	3/8	9,5	6	1/2-14	0,28	7,0	0,87	22	7/8"	1,30	33
SP02010817	1/2	12,7	8	3/8-19	0,37	9,5	0,75	19	3/4"	1,14	29
SP02010821	1/2	12,7	8	1/2-14	0,37	9,5	0,87	22	7/8"	1,34	34
SP02010827	1/2	12,7	8	3/4-14	0,37	9,5	1,06	27	1.1/16"	1,42	36
SP02011021	5/8	16	10	1/2-14	0,47	12,0	0,87	22	7/8"	1,34	34
SP02011027	5/8	16	10	3/4-14	0,47	12,0	1,06	27	1.1/16"	1,42	36
SP02011227	3/4	19	12	3/4-14	0,59	15,0	1,06	27	1.1/16"	1,46	37
SP02011233	3/4	19	12	1-11	0,59	15,0	1,42	36	1.7/16"	1,69	43
SP02011633	1	25,4	16	1-11	0,79	20,0	1,42	36	1.7/16"	1,73	44
SP02011642	1	25,4	16	1.1/4-11	0,79	20,0	1,81	46	1.13/16"	1,81	46

BSP MALE PARALLEL 60° FLARE

MASCHIO BSP CILINDRICO SVASATURA 60°

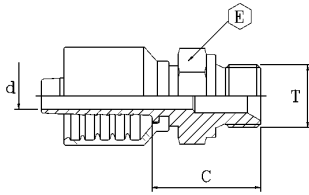

AGR

part nr. codice	hose ID		size	thread T	d		hex E		key	cut-off C	
	[in]	[mm]			[in]	[mm]	[in]	[mm]		[in]	[mm]
SP02000410	1/4	6,4	4	1/8-28	0,16	4,0	0,55	14	9/16"	0,83	21
SP02000413	1/4	6,4	4	1/4-19	0,16	4,0	0,75	19	3/4"	1,06	27
SP02000417	1/4	6,4	4	3/8-19	0,16	4,0	0,87	22	7/8"	1,10	28
SP02000421	1/4	6,4	4	1/2-14	0,16	4,0	1,06	27	1.1/16"	1,26	32
SP02000513	5/16	8	5	1/4-19	0,22	5,5	0,75	19	3/4"	1,06	27
SP02000517	5/16	8	5	3/8-19	0,22	5,5	0,87	22	7/8"	1,10	28
SP02000521	5/16	8	5	1/2-14	0,22	5,5	1,06	27	1.1/16"	1,26	32
SP02000613	3/8	9,5	6	1/4-19	0,28	7,0	0,75	19	3/4"	1,06	27
SP02000617	3/8	9,5	6	3/8-19	0,28	7,0	0,87	22	7/8"	1,14	29
SP02000621	3/8	9,5	6	1/2-14	0,28	7,0	1,06	27	1.1/16"	1,26	32
SP02000817	1/2	12,7	8	3/8-19	0,37	9,5	0,87	22	7/8"	1,14	29
SP02000821	1/2	12,7	8	1/2-14	0,37	9,5	1,06	27	1.1/16"	1,30	33
SP02000823	1/2	12,7	8	5/8-14	0,37	9,5	1,18	30	1.3/16"	1,34	34
SP02000827	1/2	12,7	8	3/4-14	0,37	9,5	1,26	32	1.1/4"	1,38	35
SP02001021	5/8	16	10	1/2-14	0,47	12,0	1,06	27	1.1/16"	1,30	33
SP02001023	5/8	16	10	5/8-14	0,47	12,0	1,18	30	1.3/16"	1,34	34
SP02001027	5/8	16	10	3/4-14	0,47	12,0	1,26	32	1.1/4"	1,38	35
SP02001221	3/4	19	12	1/2-14	0,59	15,0	1,06	27	1.1/16"	1,34	34
SP02001227	3/4	19	12	3/4-14	0,59	15,0	1,26	32	1.1/4"	1,42	36
SP02001233	3/4	19	12	1-11	0,59	15,0	1,62	41	1.5/8"	1,54	39
SP02001633	1	25,4	16	1-11	0,79	20,0	1,62	41	1.5/8"	1,58	40
SP02001642	1	25,4	16	1.1/4-11	0,79	20,0	1,97	50	2"	1,73	44

**BSP FEMALE 60° FLARE WITH
CRIMPED NUT**

**FEMMINA BSP SVASATURA 60° CON DADO
PINZATO**

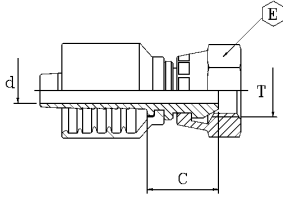

DKR

part nr. codice	hose ID			thread T	d		hex E			cut-off C	
	[in]	[mm]	size		[in]	[mm]	[in]	[mm]	key	[in]	[mm]
SP16200410	1/4	6,4	4	1/8-28	0,16	4,0	0,55	14	9/16"	0,63	16
SP16200413	1/4	6,4	4	1/4-19	0,16	4,0	0,75	19	3/4"	0,71	18
SP16200417	1/4	6,4	4	3/8-19	0,16	4,0	0,87	22	7/8"	0,79	20
SP16200421	1/4	6,4	4	1/2-14	0,16	4,0	1,06	27	1.1/16"	0,87	22
SP16200513	5/16	8	5	1/4-19	0,22	5,5	0,75	19	3/4"	0,71	18
SP16200517	5/16	8	5	3/8-19	0,22	5,5	0,87	22	7/8"	0,79	20
SP16200521	5/16	8	5	1/2-14	0,22	5,5	1,06	27	1.1/16"	0,87	22
SP16200613	3/8	9,5	6	1/4-19	0,28	7,0	0,75	19	3/4"	0,71	18
SP16200617	3/8	9,5	6	3/8-19	0,28	7,0	0,87	22	7/8"	0,79	20
SP16200621	3/8	9,5	6	1/2-14	0,28	7,0	1,06	27	1.1/16"	0,87	22
SP16200817	1/2	12,7	8	3/8-19	0,37	9,5	0,87	22	7/8"	0,79	20
SP16200821	1/2	12,7	8	1/2-14	0,37	9,5	1,06	27	1.1/16"	0,91	23
SP16200823	1/2	12,7	8	5/8-14	0,37	9,5	1,18	30	1.3/16"	0,91	23
SP16200827	1/2	12,7	8	3/4-14	0,37	9,5	1,26	32	1.1/4"	0,87	22
SP16201021	5/8	16	10	1/2-14	0,47	12,0	1,06	27	1.1/16"	0,91	23
SP16201023	5/8	16	10	5/8-14	0,47	12,0	1,18	30	1.3/16"	0,87	22
SP16201027	5/8	16	10	3/4-14	0,47	12,0	1,26	32	1.1/4"	0,87	22
SP16201227	3/4	19	12	3/4-14	0,59	15,0	1,26	32	1.1/4"	0,91	23
SP16201233	3/4	19	12	1-11	0,59	15,0	1,50	38	1.1/2"	0,99	25
SP16201633	1	25,4	16	1-11	0,79	20,0	1,50	38	1.1/2"	1,02	26

**BSP 45° FEMALE 60° FLARE WITH
CRIMPED NUT**

**FEMMINA BSP 45° SVASATURA 60° CON
DADO PINZATO**

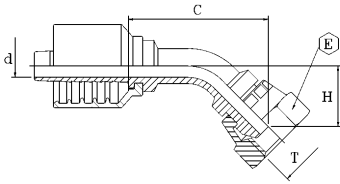

DKR-45

part nr. codice	hose ID			thread T	d		hex E			cut-off C		drop H	
	[in]	[mm]	size		[in]	[mm]	[in]	[mm]	key	[in]	[mm]	[in]	[mm]
SP28200413	1/4	6,4	4	1/4-19	0,16	4,0	0,75	19	3/4"	1,38	35,0	0,63	16,0
SP28200413L	1/4	6.04	4	1/4-19	0,01	0,2	0,75	19	3/4"	1,62	41,0	0,63	16,0
SP28200417	1/4	6,4	4	3/8-19	0,16	4,0	0,87	22	7/8"	1,69	43,0	0,71	18,0
SP28200517	5/16	8	5	3/8-19	0,22	5,5	0,87	22	7/8"	1,97	50,0	0,75	19,0
SP28200617	3/8	9,5	6	3/8-19	0,28	7,0	0,87	22	7/8"	2,04	52,0	0,75	19,0
SP28200621	3/8	9,5	6	1/2-14	0,28	7,0	1,06	27	1.1/16"	2,08	53,0	0,79	20,0
SP28200821	1/2	12,7	8	1/2-14	0,37	9,5	1,06	27	1.1/16"	1,97	50,0	0,91	23,0
SP28200823L	1/2	12,7	8	5/8-14	0,37	9,5	1,18	30	1.3/16"	2,56	65,0	0,95	24,0
SP28200827	1/2	12,7	8	3/4-14	0,37	9,5	1,26	32	1.1/4"	2,56	65,0	0,91	23,0
SP28201023	5/8	16	10	5/8-14	0,47	12,0	1,18	30	1.3/16"	2,75	70,0	1,02	26,0
SP28201027	5/8	16	10	3/4-14	0,47	12,0	1,26	32	1.1/4"	2,75	70,0	1,02	26,0
SP28201227	3/4	19	12	3/4-14	0,59	15,0	1,26	32	1.1/4"	3,30	84,0	1,06	27,0
SP28201233	3/4	19	12	1-11	0,59	15,0	1,50	38	1.1/2"	3,42	87,0	1,18	30,0
SP28201633	1	25,4	16	1-11	0,79	20,0	1,50	38	1.1/2"	3,30	84,0	1,38	35,0

**BSP 90° FEMALE 60° FLARE WITH
CRIMPED NUT**

**FEMMINA BSP 90° SVASATURA 60° CON
DADO PINZATO**

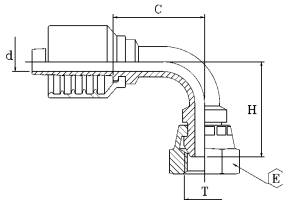

DKR-90

part nr. codice	hose ID			thread T	d		hex E			cut-off C		drop H	
	[in]	[mm]	size		[in]	[mm]	[in]	[mm]	key	[in]	[mm]	[in]	[mm]
SP27200413	1/4	6,4	4	1/4-19	0,16	4,0	0,75	19	3/4"	0,99	25	1,10	28
SP27200417	1/4	6,4	4	3/8-19	0,16	4,0	0,87	22	7/8"	0,99	25	1,22	31
SP27200517	5/16	8	5	3/8-19	0,22	5,5	0,87	22	7/8"	1,14	29	1,42	36
SP27200617	3/8	9,5	6	3/8-19	0,28	7,0	0,87	22	7/8"	1,30	33	1,38	35
SP27200621	3/8	9,5	6	1/2-14	0,28	7,0	1,06	27	1.1/16"	1,30	33	1,46	37
SP27200817	1/2	12,7	8	3/8-19	0,37	9,5	0,87	22	7/8"	1,54	39	1,62	41
SP27200821	1/2	12,7	8	1/2-14	0,37	9,5	1,06	27	1.1/16"	1,54	39	1,62	41
SP27200823	1/2	12,7	8	5/8-14	0,37	9,5	1,18	30	1.3/16"	1,54	39	1,73	44
SP27200827	1/2	12,7	8	3/4-14	0,37	9,5	1,26	32	1.1/4"	1,54	39	1,73	44
SP27201023	5/8	16	10	5/8-14	0,47	12,0	1,18	30	1.3/16"	1,77	45	1,93	49
SP27201027	5/8	16	10	3/4-14	0,47	12,0	1,26	32	1.1/4"	1,77	45	2,01	51
SP27201227	3/4	19	12	3/4-14	0,59	15,0	1,26	32	1.1/4"	2,21	56	2,13	54
SP27201233	3/4	19	12	1-11	0,59	15,0	1,50	38	1.1/2"	2,21	56	2,29	58
SP27201633	1	25,4	16	1-11	0,79	20,0	1,50	38	1.1/2"	2,76	70	2,56	65

**BSP 90° COMPACT FEMALE 60°
FLARE WITH CRIMPED NUT**

**FEMMINA COMPATTA BSP 90° SVASATURA
60° CON DADO PINZATO**

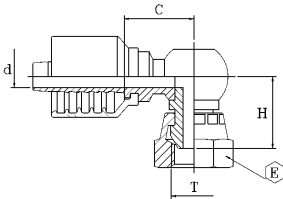

DKR-90-K

part nr. codice	hose ID		size	thread T	d		hex E		key	cut-off C		drop H	
	[in]	[mm]			[in]	[mm]	[in]	[mm]		[in]	[mm]	[in]	[mm]
SP41200413	1/4	6,4	4	1/4-19	0,16	4,0	0,75	19	3/4"	0,99	25	0,83	21
SP41200517	5/16	8	5	3/8-19	0,22	5,5	0,87	22	7/8"	1,02	26	0,87	22
SP41200617	3/8	9,5	6	3/8-19	0,28	7,0	0,87	22	7/8"	1,02	26	0,87	22
SP41200621	3/8	9,5	6	1/2-14	0,28	7,0	1,06	27	1.1/16"	1,02	26	1,02	26
SP41200821	1/2	12,7	8	1/2-14	0,37	9,5	1,06	27	1.1/16"	1,06	27	1,06	27
SP41201023	5/8	16	10	5/8-14	0,47	12,0	1,18	30	1.3/16"	1,06	27	1,14	29
SP41201227	3/4	19	12	3/4-14	0,59	15,0	1,26	32	1.1/4"	1,22	31	1,14	29
SP41201633	1	25,4	16	1-11	0,79	20,0	1,50	38	1.1/2"	1,46	37	1,38	35

BSP FEMALE FLAT FACE

FEMMINA BSP FACCIA PIANA

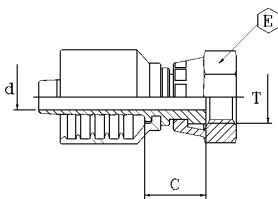

DKR-F

part nr. codice	hose ID		size	thread T	d		hex E		key	cut-off C	
	[in]	[mm]			[in]	[mm]	[in]	[mm]		[in]	[mm]
SP16500413	1/4	6,4	4	1/4-18	0,16	4,0	0,75	19	3/4"	0,55	14
SP16500417	1/4	6,4	4	3/8-19	0,16	4,0	0,87	22	7/8"	0,59	15
SP16500617	3/8	9,5	6	3/8-19	0,28	7,0	0,87	22	7/8"	0,59	15
SP16500621	3/8	9,5	6	1/2-14	0,28	7,0	0,87	22	7/8"	0,63	16
SP16500821	1/2	12,7	8	1/2-14	0,37	9,5	1,06	27	1.1/16"	0,63	16
SP16500827	1/2	12,7	8	3/4-14	0,37	9,5	1,26	32	1.1/4"	0,79	20
SP16501227	3/4	19	12	3/4-14	0,59	15,0	1,26	32	1.1/4"	0,71	18
SP16501633	1	25,4	16	1-11	0,79	20,0	1,50	38	1.1/2"	0,79	20

BSP BANJO

OCCHIO A PRESSARE BSP

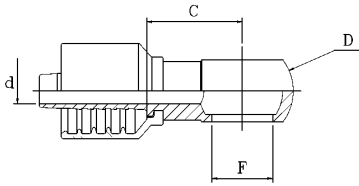

RNR

part nr. codice	hose ID			hole F			d		D		cut-off C	
	[in]	[mm]	size	[in]	[mm]	size	[in]	[mm]	[in]	[mm]	[in]	[mm]
SP50000410	1/4	6,4	4	0,40	10,1	1/8	0,16	4,0	0,67	17,0	0,99	25
SP50000413	1/4	6,4	4	0,52	13,3	1/4	0,16	4,0	0,95	24,0	1,02	26
SP50000417	1/4	6,4	4	0,66	16,8	3/8	0,16	4,0	1,10	28,0	1,02	26
SP50000513	5/16	8	5	0,52	13,3	1/4	0,22	5,5	0,95	24,0	1,02	26
SP50000517	5/16	8	5	0,66	16,8	3/8	0,22	5,5	1,10	28,0	1,02	26
SP50000613	3/8	9,5	6	0,52	13,3	1/4	0,28	7,0	0,95	24,0	1,14	29
SP50000617	3/8	9,5	6	0,66	16,8	3/8	0,28	7,0	1,10	28,0	1,02	26
SP50000621	3/8	9,5	6	0,83	21,1	1/2	0,28	7,0	1,42	36,0	1,22	31
SP50000817	1/2	12,7	8	0,66	16,8	3/8	0,39	10,0	1,10	28,0	1,06	27
SP50000821	1/2	12,7	8	0,83	21,1	1/2	0,39	10,0	1,42	36,0	1,22	31
SP50000827	1/2	12,7	8	1,05	26,6	3/4	0,39	10,0	1,77	45,0	1,50	38
SP50001023	5/8	16	10	0,91	23,1	5/8	0,47	12,0	1,58	40,0	1,50	38
SP50001227	3/4	19	12	1,05	26,6	3/4	0,59	15,0	1,77	45,0	1,50	38
SP50001233	3/4	19	12	1,32	33,5	1	0,59	15,0	2,29	58,0	1,97	50
SP50001633	1	25,4	16	1,32	33,5	1	0,79	20,0	2,29	58,0	2,01	51

BSP BOLT

BULLONE FORATO BSP

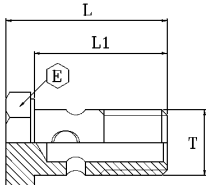

BFG

part nr. codice	thread T	L		L1		hex E		
		[in]	[mm]	[in]	[mm]	[in]	[mm]	key
1555010000	1/8-28	0,95	24,0	0,77	19,5	0,55	14	9/16"
1555013312	1/4-19	1,36	34,5	1,12	28,5	0,75	19	3/4"
1555017400	3/8-19	1,60	40,5	1,30	33,0	0,87	22	7/8"
1555021460	1/2-14	1,81	46,0	1,50	38,0	1,06	27	1.1/16"
1555023500	5/8-14	1,97	50,0	1,65	42,0	1,18	30	1.3/16"
1555027690	3/4-14	2,21	56,0	1,85	47,0	1,26	32	1.1/4"
1555033860	1-11	2,72	69,0	2,29	58,0	1,62	41	1.5/8"

Two copper washers for bolt must be ordered separately
 Le due rondelle di rame per bullone devono essere ordinate separatamente.

**BSP PARALLEL SWIVEL MALE 60°
FLARE**

**MASCHIO BSP PARALLELO GIREVOLE
SVASATURA 60°**

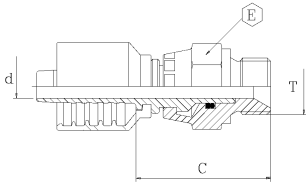

AGR-RO

part nr. codice	hose ID			thread T	hex E		cut-off C		
	[in]	[mm]	size		[in]	[mm]	key	[in]	[mm]
SP09200413	1/4	6,4	4	1/4-19	0,75	19	3/4"	1,69	43
SP09200521	5/16	7,9	5	1/2-14	1,06	27	1.1/16"	1,73	44
SP09200617	3/8	9,5	6	3/8-19	0,87	22	7/8"	1,73	44
SP09200821	1/2	12,7	8	1/2-14	1,06	27	1.1/16"	1,89	48
SP09201227	3/4	19,0	12	3/4-14	1,26	32	1.1/4"	2,13	54
SP09201633	1	25,4	16	1-11	1,62	41	1.5/8"	2,32	59

WASH CLEANER FEMALE

FEMMINA PER IDROPULTRICI

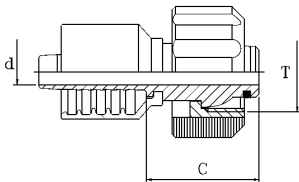

K

part nr. codice	hose ID			thread T	d		cut-off C	
	[in]	[mm]	size		[in]	[mm]	[in]	[mm]
SP08000422	1/4	6,4	4	M22-1.5	0,16	4,0	1,21	30,7
SP08000522	5/16	7,9	5	M22-1.5	0,22	5,5	1,21	30,7
SP08000622	3/8	9,5	6	M22-1.5	0,28	7,0	1,21	30,7